

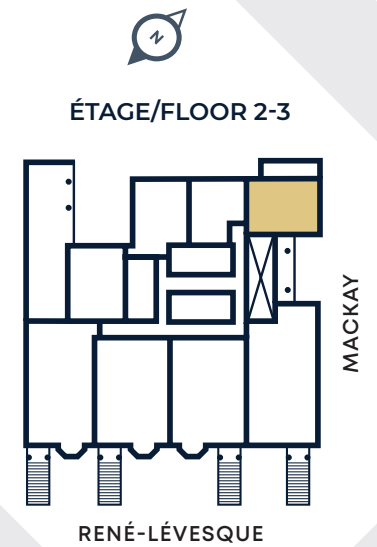

 594 PI<sup>2</sup> / FT<sup>2</sup>

- 1** 8'7" X 5'7"
- 2** 8'7" X 12'5"
- 3** 10'3" X 9'8"
- 4** 8'1" X 5'9"



DATE DE RÉVISION

VEND. / SALER

DATE

VEND. / SALER

DATE